

Instructions for F200 Lint Hog™



Please read before use.



Register your product
at <http://www.mytee.com/support/register>

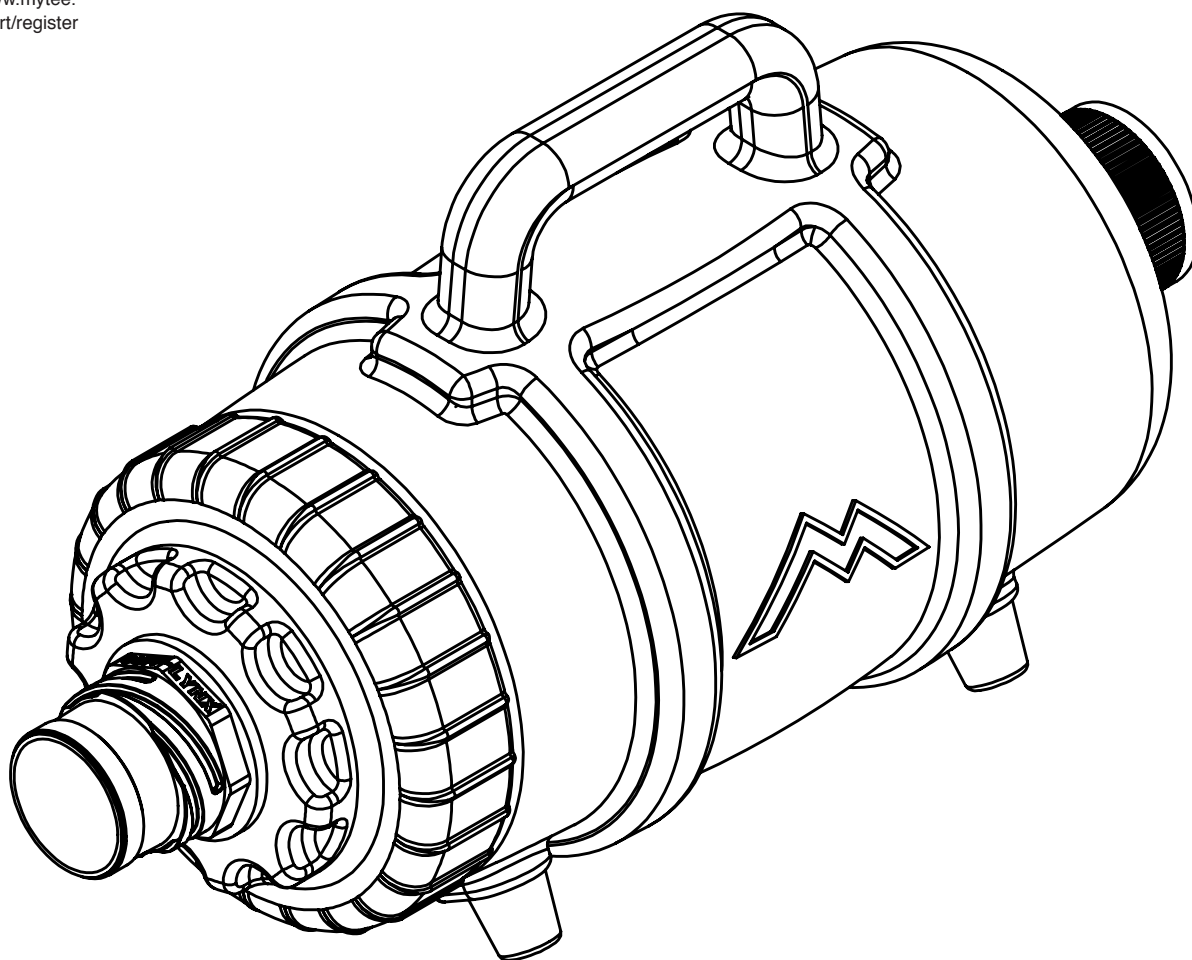

[General Information p. 2](#)
[Using the F200 Lint Hog™ p. 3](#)
[Parts & Pricing p. 5](#)
[Notes p. 6](#)

Model # _____

Serial # _____

Form # ADP-F200

7-16

GENERAL INFORMATION

Dear Customer:

Congratulations on the purchase of your new Lint Hog™. Just one example of how Mytee Products Inc., is strive to keep you on the cutting edge with superior quality and technology.

Neglect or abuse of the Lint Hog™ will void the warranty. With simple maintenance this product will give quality performance for many years to come.

If warranty questions arise, please consult user manual or get in touch with your distributor. If you have questions about maintenance, replacing parts or ordering parts, please call an authorized Mytee Products Inc. Service Center. To see an updated list, visit our website at www.mytee.com.

Before you begin using, please read your manual thoroughly.

Sincerely,
Mytee Customer Care Dept.

Parts and Service

Repairs, when required, should be performed by Mytee service personnel or Mytee authorized Service Center using Mytee original replacement parts and accessories. Call Mytee for repair parts or service. Please specify the Model and Serial Number when discussing your machine.

Unpacking the Machine

When the machine is delivered, carefully inspect the shipping carton and the machine for damage. If damage is evident, save the shipping carton so that it can be inspected by the carrier that delivered it. Contact the carrier immediately to file a freight damage claim.

After Use

1. Disconnect the Lint Hog™ from vacuum hoses at both ends, make sure the unit is emptied and cleaned for the next job.
2. Store indoors in a clean, dry place.

Maintenance Schedule

Make sure unit is emptied and cleaned after each use.

Troubleshooting

My Lint Hog™ isn't collecting debris.

1. Make sure the stainless steel filter has been emptied and cleaned. Check that your vacuum hoses are correctly attached to both hose inlets, and the wand and extractor. Also, make sure that your wand and extractor are in good working order.

Machine Specifications

Filter	12" stainless steel strainer basket
Inlets	One 2" male Cuff-Lynx™ connection and one 2" female Cuff-Lynx™
Construction	Durable roto-molded polyethylene
Product Weight	5 lbs.
Machine Dimensions	20.75" x 8" x 11.5"

F200 LINT HOG™ SIDE VIEW

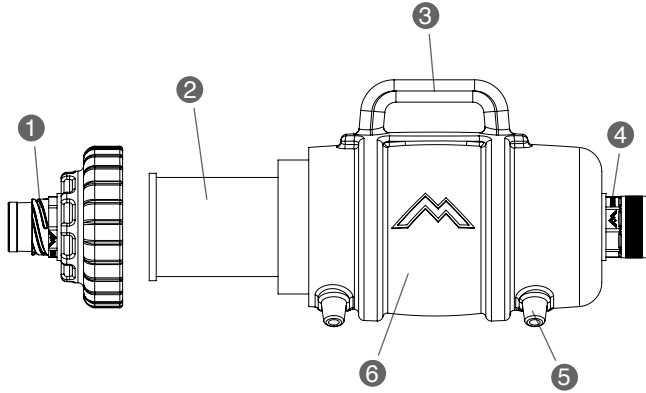

1. 2" Cuff-Lynx™ to cleaning tool
2. Stainless steel strainer basket
3. Handle
4. 2" Cuff-Lynx™ to extractor
5. Rubber feet
6. Translucent, roto-molded polyethylene body

INCLUDED ACCESSORIES

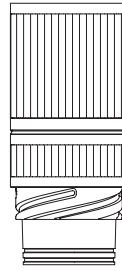

H136 - Coupler Swivel,
2" male x 2" female vac hose

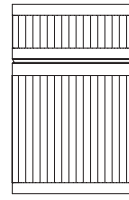

H110 - Coupler Swivel,
2" female x 2" female vac hose

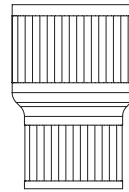

H141 - Reducer,
2" female x 1.5" female vac hose



G008 - Pack of Piglet™
filters

REPLACING HOSE CUFFS WITH CUFF-LYNX™

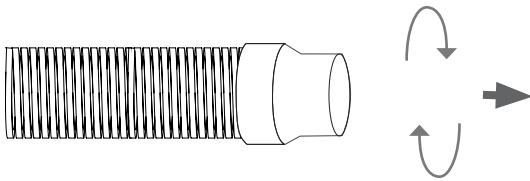

Twist clock-wise to remove standard cuffs.

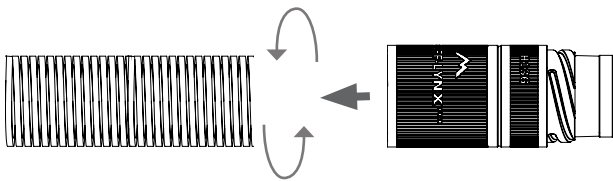

Twist counter clock-wise to attach Cuff-Lynx™ to vac. hose.

Once you receive your Lint Hog™, you will need to replace the cuffs on your vacuum hose. To remove old cuffs, twist clock-wise. To attach either male, female or reducer Cuff-lynx™ to vacuum hose twist counter clock-wise.

PIGLET FILTER & STRAINER BASKET

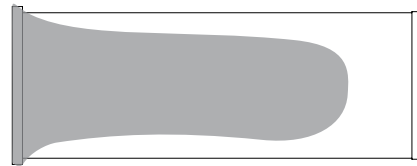

Insert one of the Piglet™ filters over the strainer basket opening for added protection. Once Piglet™ is added, insert strainer basket within the Lint Hog™

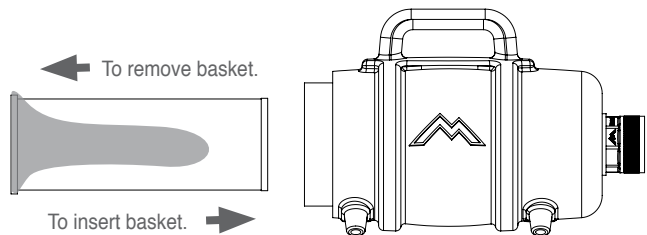

When the strainer basket fills up or you notice a change in performance, empty the unit, clean the strainer basket, and replace the Piglet™ filter. Insert the strainer basket back in the Lint Hog™.

LINT HOG™ SET UP

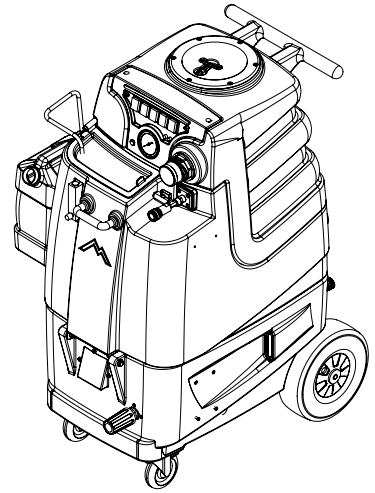
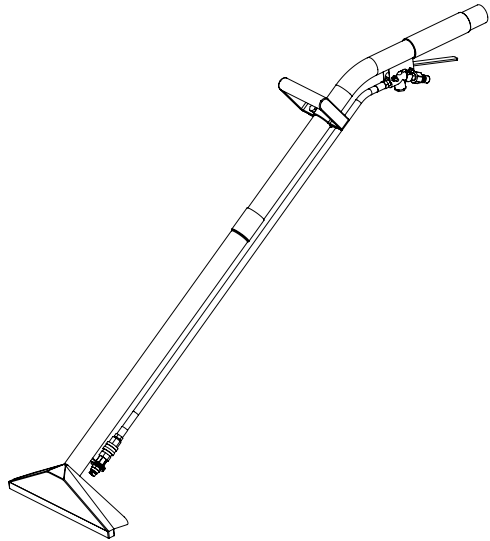

Position the Lint Hog™ in line between the cleaning tool and the truckmount or portable extractor. Using vacuum hoses with 2" Cuff-Lynx™ hose connectors, connect the cap end of the Lint Hog™ to your cleaning tool and connect the female Cuff-Lynx™ end to your extractor or truckmount.

F200 LINT HOG™ PARTS & PRICING

ITEM NO.	PART NO.	DESCRIPTION	QTY.	MSRP
1	H135	Cuff-Lynx, 2" m cuff x 2" mpt.	1	\$3.99 ea
2	P561	cap, 6", threaded, w/ 2" mpt	1	\$23.99 ea
3	G031	gasket, 3.25" i.d. x 5.88" o.d.	1	\$6.99 ea
4	H359	basket, strainer, 4.5 DIA x 12.5	1	\$36.99 ea
5	G084	gasket, 4.55" x 5.5"	1	\$4.99 ea
6	P563A	body, lint hog, new style	1	\$34.99 ea
7	G211	rubber feet, 1-1/8" bas diag, 1" height	4	\$3.99 ea
8	H289	Washer #10 flat, s/s	4	\$0.99 ea
9	H231	screw, 10-32 x 1" phil pan head, s/s	4	\$0.99 ea
10	H124	Cuff-Lynx, 2" mpt x 2" female cuff	1	\$3.99 ea

ACCESSORIES NOT SHOWN

PART NO.	DESCRIPTION	QTY.	MSRP
ADM-F200	manual, lint hog, QR codes	1	
G008	SEE PAK NUMBER black piglet filters - bag of 25	1	\$6.29 ea
H110	Cuff-Lynx, 2" hose x 2" f swivel	1	\$3.99 ea
H136	Cuff-Lynx, 2" hose x 2" male swivel	1	\$3.99 ea
H141	Cuff-Lynx, 2" hose to 1.5" reducer	1	\$3.99 ea

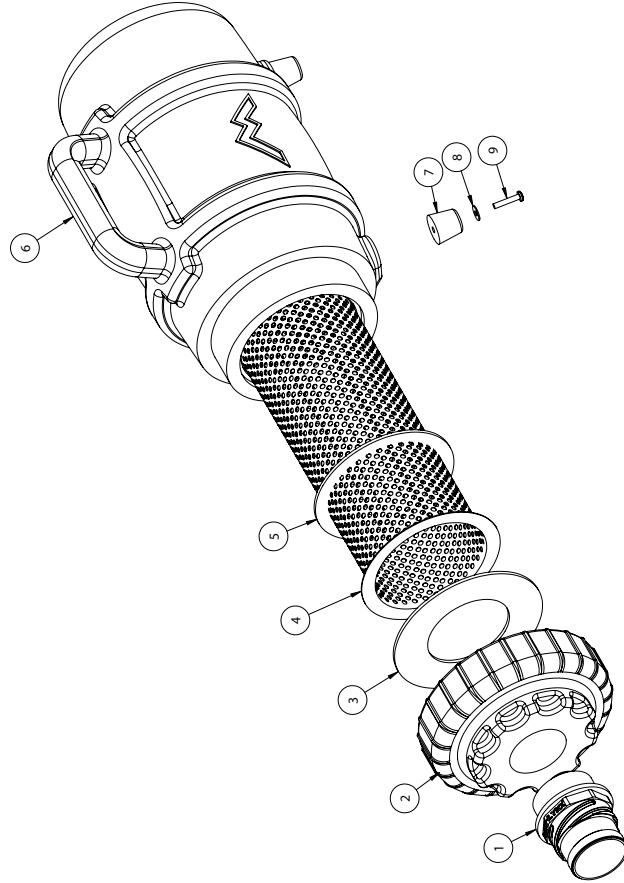
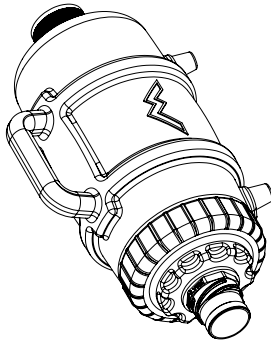

NAME M. L. Latham	DATE 5/20/11	mytee PRODUCTS, INC. 805-670-1136
CHECKED	TITLE	2" lint hog
SIZE DWG. NO.	REV	C F200 OD
SCALE: 1:3	SHEET NO.	1 OF 1

PROVIDED AND CORRECTED:
THIS DRAWING IS THE SOLE PROPERTY OF
MYTEE PRODUCTS, INC. NO PARTS OR MATERIALS
HEREON SHALL BE REPRODUCED OR TRANSMITTED
IN ANY FORM OR BY ANY MEANS, ELECTRONIC OR
MECHANICAL, INCLUDING PHOTOCOPYING, RECORDING,
OR BY ANY INFORMATION STORAGE AND RETRIEVAL
SYSTEMS, WITHOUT PERMISSION IN WRITING FROM
MYTEE PRODUCTS, INC. ©

Part prices are subject to change.

NOTES



Mytee Products Inc.
13655 Stowe Dr.
Poway, CA 92064
www.mytee.com

© 2016 Mytee Products Inc.
Printed in the U.S.A.